

 X 14
small triangle

 X 1
square

 X 4
rectangle

 X 16
big triangle

 X 9
semi-circle

Glue the bricks in the patterns shown in the manual.

1 Arrange the bricks and glue as shown.



NOTE Use the big triangle whenever you see the blue border on a triangle brick.



2 Use the big triangles to build a claw.



Repeat the steps to build the second claw.

3 Build the 1st (fore) pair of legs.



Repeat the steps to build the second leg.

4 Build the 2nd (hind) pair of legs.



Repeat the steps to build the second leg.

5 Now all the parts are ready to be glued together.

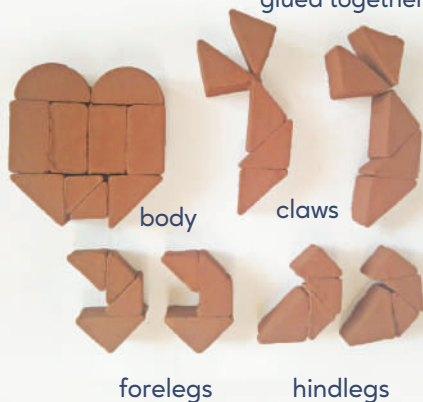

6 Glue all the parts together.

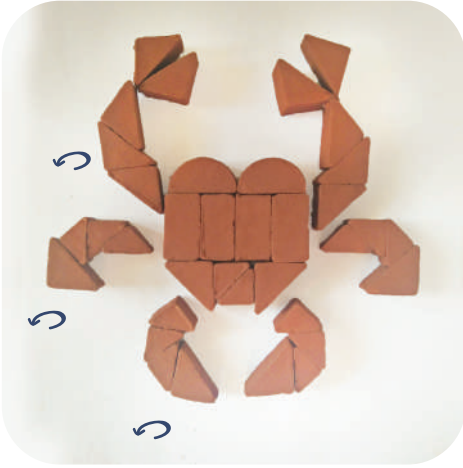

7 Final step!

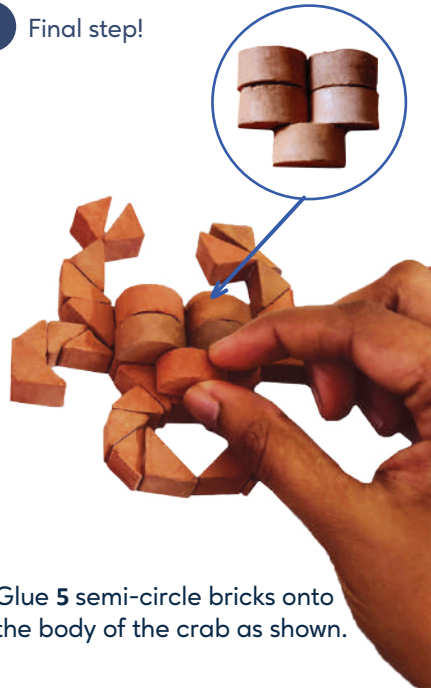

Glue 5 semi-circle bricks onto the body of the crab as shown.

SHOW OFF YOUR CREATIONS
AND TAG US!

 @pipalleaf

 @thepipalleaf

ONLINE STORE

store.pipalleaf.in

 www.pipalleaf.in

STEP-BY-STEP GUIDE TO BUILD
KATTOOS D.I.Y. CRAB



SCAN QR CODE
TO WATCH A
VIDEO TUTORIAL!
<https://rb.gy/q7zwqu>